

**FPU® SYSTEMS OPERATION MANUAL  
BOH PORTABLE DRAWER MODULE (PDM)  
(INCLUDING REPAIR PARTS & SPECIAL TOOL LIST)  
BOH FPU Field Pack-up Units**

**CHAPTER 5**

**UNIT MAINTENANCE INSTRUCTIONS**

This page was intentionally left blank

**UNIT MAINTENANCE INSTRUCTIONS****FPU® SYSTEMS OPERATION MANUAL  
BOH PORTABLE DRAWER MODULE (PDM)  
(INCLUDING REPAIR PARTS & SPECIAL TOOL LIST)  
BOH FPU Field Pack-up Units****RIVET REPLACEMENT****INITIAL SETUP:****Materiel/Parts**

None

**Personnel Required**

One

**Tools**

Rags, 1/4 hp. Electric Drill, Pop Rivet Tool, 3/16" drill bit

**References**

WP 0008 00

**Equipment Condition**

BOH PDM Drawer Repair

**INSPECT AND REPAIR**

With drawers empty and open, inspect drawer handles, side, front and rear divider supports for loose, damaged or missing rivets. Replace rivets as follows.

**REPAIR OR REPLACE DRAWER RIVETS**

1. Remove the entire contents of the drawer.

**NOTE**

In some instances the rivets may be removed without removing the drawer.

2. Remove the drawer from the tray assembly; review chapter 2 WP 0008 00.
3. Wipe the rivet surfaces clean, use a 1/2 hp. electric drill (1) with a 3/16" drill bit (2), and drill through the center core of the rivet (3).

**WARNING**

Use proper eye protection when operating a drill.

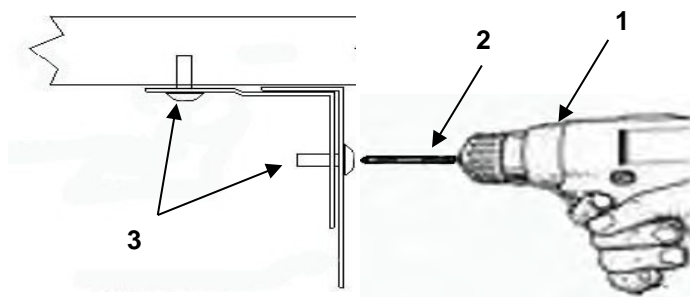

4. Remove the remainder of any pop rivet debris with needle nose pliers and wipe the hole clean with a rag.
5. Insure the holes are properly aligned.
6. Insert a new pop rivet, 3/16" DIA (2), through the holes of both items to be secured and into the pop rivet tool (1).
7. Use the pop rivet tool (1) to secure the pop rivet (2) and item in place.
8. Check for proper alignment and tight attachment of the item.
9. Return the Drawer to the tray assembly; review chapter 2 WP 0008 00.

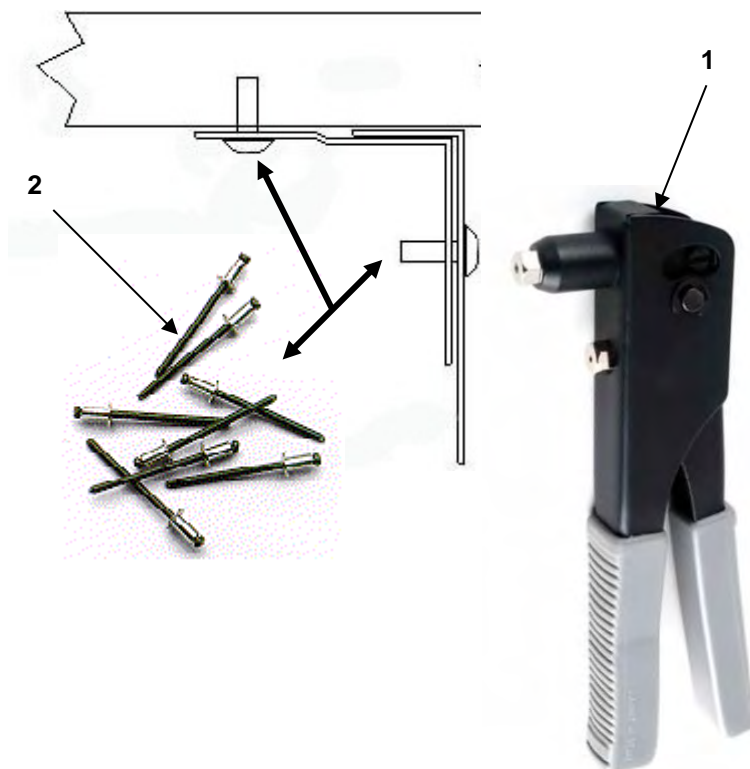

**END OF WORK PACKAGE**

**UNIT MAINTENANCE INSTRUCTIONS****FPU® SYSTEMS OPERATION MANUAL  
BOH PORTABLE DRAWER MODULE (PDM)  
(INCLUDING REPAIR PARTS & SPECIAL TOOL LIST)  
BOH FPU Field Pack-up Units****DRAWER ASSEMBLY****INITIAL SETUP:****Materiel/Parts**

None

**Personnel Required**

One

**References**

Chapter 2 WP 0008 00-2

**Equipment Condition**

BOH PDM MODULES Set-up

**INSPECT, REPAIR**

1. With the drawer pulled to the full extended position, unlatch the drawer and raise the lid (1) to the full open position; replace damaged hinge.
2. Check for missing or damaged drawer lid latches (2); replace as needed.

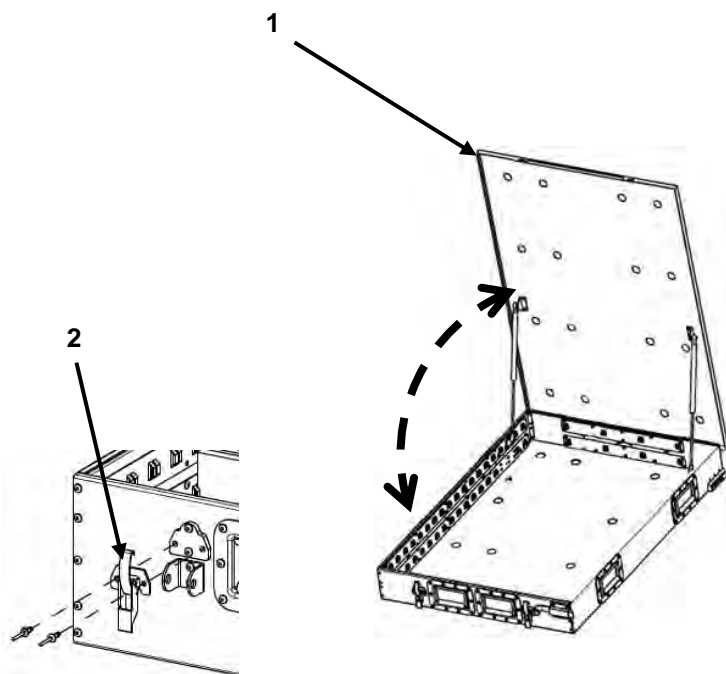
**END OF WORK PACKAGE**

This page was intentionally left blank

## UNIT MAINTENANCE INSTRUCTIONS

### FPU® SYSTEMS OPERATION MANUAL BOH PORTABLE DRAWER MODULE (PDM) (INCLUDING REPAIR PARTS & SPECIAL TOOL LIST) BOH FPU Field Pack-up Units

#### DRAWER LID SEALS AND CYLINDERS

---

#### INITIAL SETUP:

##### Materiel/Parts

Drawer Seal and Gas Cylinder Kits

##### Personnel Required

Two

##### Tools

Flat Tip Screwdriver, Putty Knife, Wire Brush and Rags

##### References

Chapter 2 WP 0008 00-2

##### Equipment Condition

BOH PDM Drawer Repair

---

#### INSPECT, REPAIR

With the drawer lid in the fully open position, inspect the two strut cylinders for freedom of movement, proper support, bent or damaged shaft, or cylinder

#### NOTE

It is recommended that both strut cylinders be replaced as a set if damage or wear should occur.



#### WARNING

Missing or damaged retainer clips (1) or mounting brackets (2) will cause injury to personnel during operation of the drawer lid. Replace any damaged or missing items immediately.

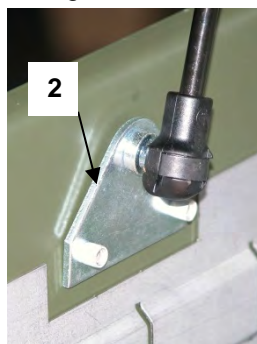
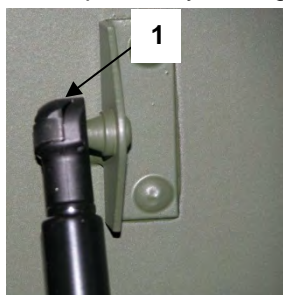

**NOTE**

Only remove or replace one cylinder (1) at a time to maintain strut support to the lid.

1. Pry the spring retainer clip (2) from the cylinder strut heads (3) with a flat tip screw driver or pocket knife.
2. Pull the cylinder head (3) away from the mounting bracket (4 and 5).
3. Replace the strut cylinder (1), both cylinder strut heads (3) and retaining clips (2) onto the mounting brackets (4 and 5).
4. Remove the second cylinder, retaining clips (2) and cylinder heads (3) from the brackets (4 and 5).
5. Replace the second cylinder (1), both cylinder strut head (3) and retaining clips (2).

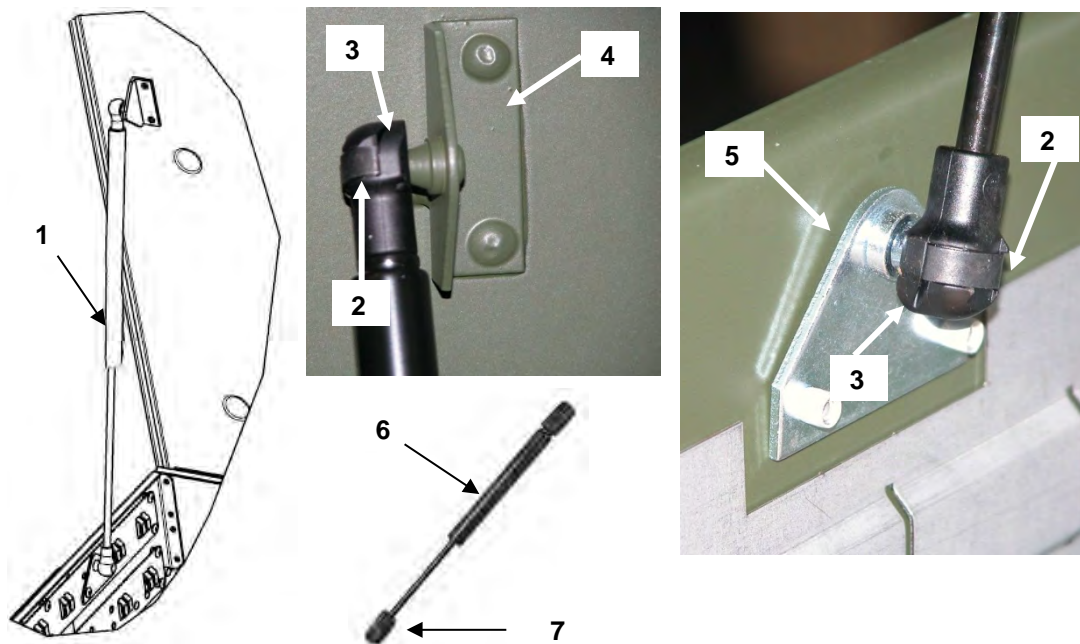
**CAUTION**

Always replace the cylinders with the cylinder chamber end (6) attached to the lid bracket (4) and the shaft end (7) to the drawer bracket (5). The oil within the chamber (6) prevents premature wear of the cylinder seals.



## INSPECT

With the drawer lid (1) in the fully open position, inspect the lid seal (2) for cracks, cuts and distortion or separation.

## REPLACE DRAWER LID SEALS

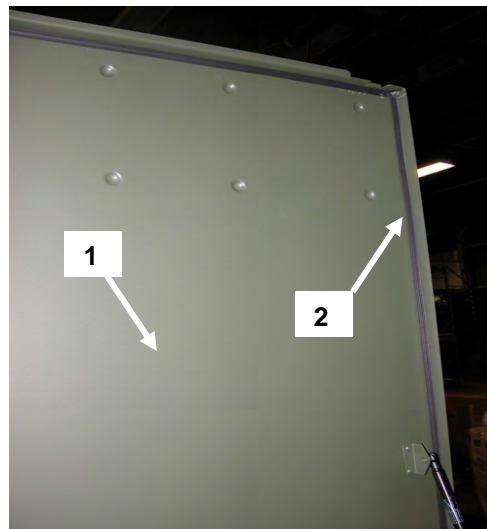

1. Close the lid (1) and remove the drawer from the tray, refer to WP 0006 00.
2. Place drawer on a firm surface with the seal (2) up; remove the entire seal with a putty knife, pocket knife or other sharp instrument.
3. Clean the remaining glue from the lid with a solvent and rag or wire brush.
4. Cut the new seal to desired length and apply the self-adhesive seal to a clean dry surface.

### NOTE

The seal should be applied in its relaxed state and should not be stretched.

5. After the seal is firmly set in place, visually inspect the seal (2) for tightness and alignment in the lid.
6. Return the drawer to the tray and return the drawer to the stowed position, refer to chapter 2 page WP 0008 00-2.
7. Ensure the drawer lid latches and slam latch are secure, refer to WP 0008 00-2.

## END OF WORK PACKAGE

This page was intentionally left blank

**UNIT MAINTENANCE INSTRUCTIONS****FPU® SYSTEMS OPERATION MANUAL  
BOH PORTABLE DRAWER MODULE (PDM)  
(INCLUDING REPAIR PARTS & SPECIAL TOOL LIST)  
BOH FPU Field Pack-up Units****TRAY and CASE ASSEMBLY****INITIAL SETUP:****Materiel/Parts**

None

**Personnel Required**

Two and Certified Welder

**Tools**

Welding shop equipment

**References**

Chapter 2 0006 00

**Equipment Condition**

BOH PDM MODULE Repair

**WELDING REPAIR**

Welding repairs are only required when the BOH PDM MODULE tray and case assembly is pierced, punctured, cracked or broken. Standard welding principles and materials apply to BOH PDM MODULE repairs. Welding procedures will not be discussed in this manual. Refer to TC 9-237 for welding procedures.

**REPLACE OR REPAIR DRAWER TRAY AND CASE UNIT**

1. Remove all stored material from the drawer.
2. Remove both ratchet straps (1) from the stack.

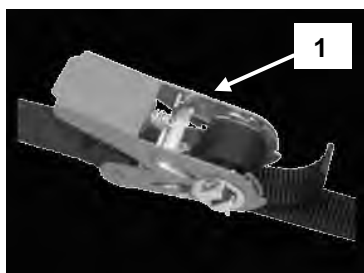

3. Release the drawer assembly (1) from the inner slide tray (2).

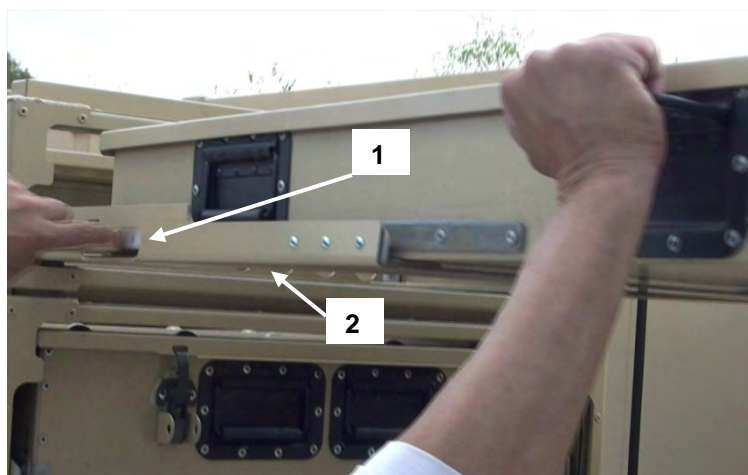

With assistance remove the tray and case assembly (3) from the stack to be repaired or replaced; refer to chapter 2 WP 0008 00.

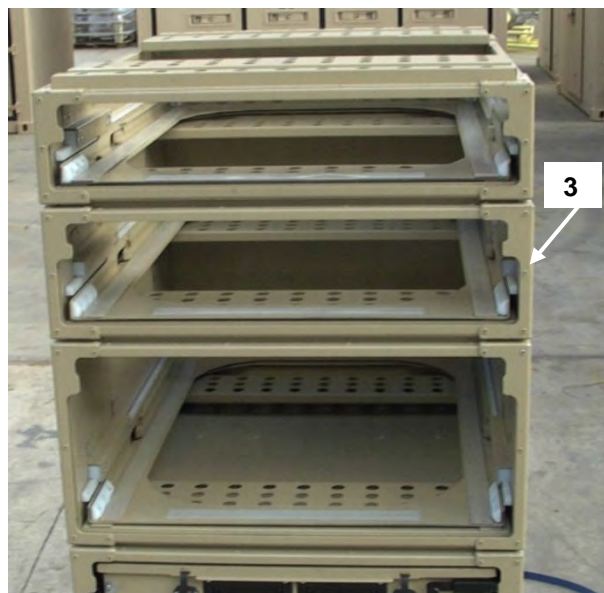

5. Inspect and make welding repairs or replace the tray case assembly (3), review chapter 2 WP 0008 00.
6. Inspect the tray and case guide strips for damage; replace or repair as needed.
7. Install the new or repaired tray and case assembly on the stack, refer to chapter 2 WP 0006 00.
8. Reinstall both ratchet straps.
9. Pull out the tray, reinstall the drawer.
10. Ensure the slam latch is engaged

## END OF WORK PACKAGE

## UNIT MAINTENANCE INSTRUCTIONS

### FPU® SYSTEMS OPERATION MANUAL BOH PORTABLE DRAWER MODULE (PDM) (INCLUDING REPAIR PARTS & SPECIAL TOOL LIST) BOH FPU Field Pack-up Units

#### PDM TRAY GUIDES and CASE PADS

##### INITIAL SETUP:

###### Material/Parts

Guide and Pad Repair Kits

###### Personnel Required

Two plus Supervisor

###### Tools

Rags, 1/2 hp. Electric Drill, Pop Rivet Tool, 3/16" drill bit and putty knife

###### References

Chapter 2 WP 0006 00

###### Equipment Condition

BOH PDM MODULE Repair

##### INSPECT

Inspect all sets of tray and case slide pads (1) for cracks, breaks, uneven or excessive wear that impedes smooth operation of the drawer.

##### REPLACE TRAY AND CASE ASSEMBLY SLIDE PADS

1. Remove all material from the drawer.
2. Remove the drawer from the tray.
3. Remove the case and tray assembly (2) from the module stack.



**WARNING**

Seek assistance to remove the drawers. Seek assistance to remove tray and case assembly from the module stack.

4. Remove the tray from the case and tray assembly (2), review chapter 2 WP 0006 00.

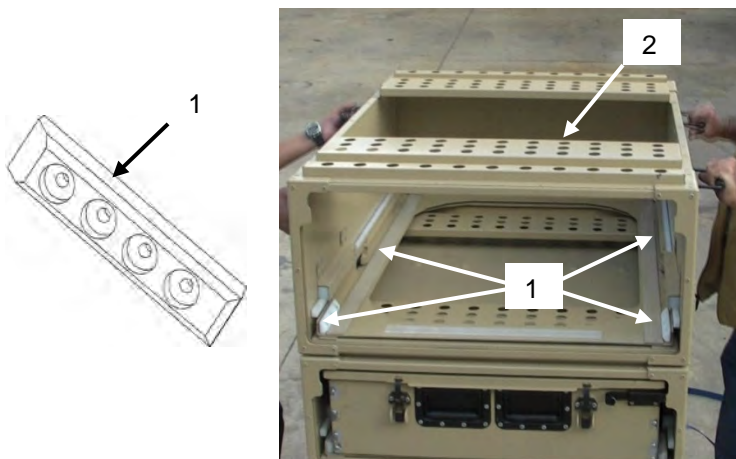

5. Place the tray and case assembly (1) on a firm, flat surface.
6. Wipe the rivet surfaces clean, use a 1/2 hp. electric drill with a 3/16" drill bit (2), and drill through the center core of the pop rivets (3).
7. Replace the entire set of guides if they are damaged or worn.

**WARNING**

Use proper eye protection when operating a drill or grinder or when welding.

8. Remove the remainder of any rivet debris with needle nose pliers and wipe the hole clean with a rag.

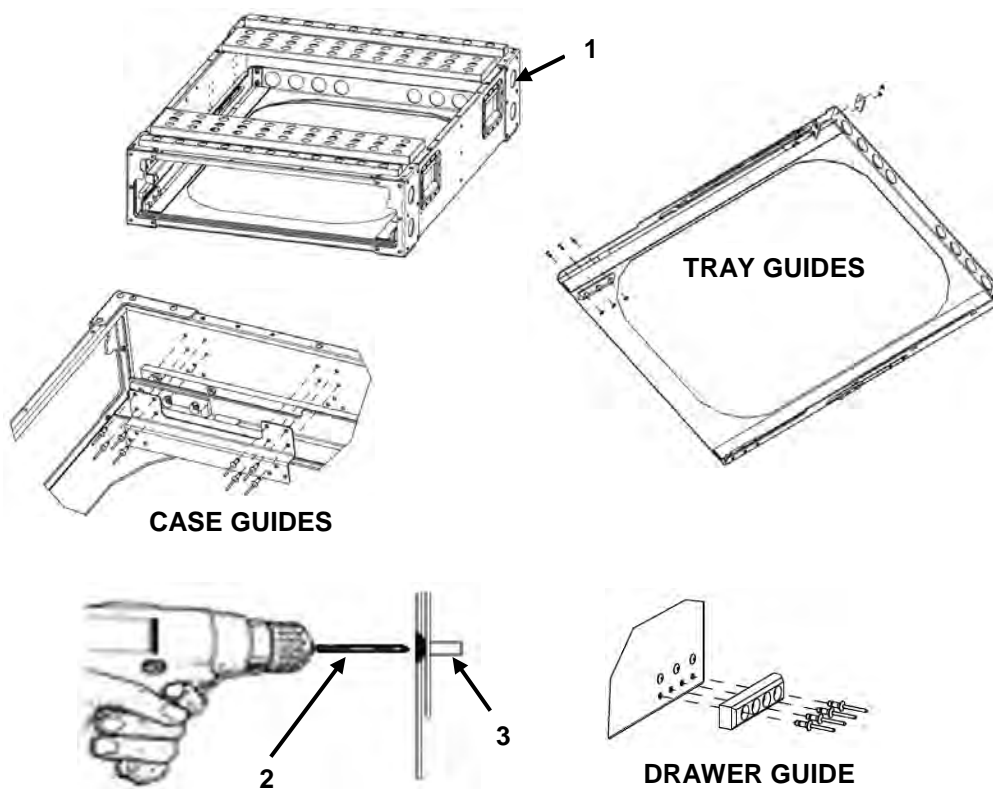

## INSTALL NEW GUIDES

1. Insure the replacement slide guide holes are properly aligned with the tray drawer and case holes. Drilling new holes should not be required.

### WARNING



The Drawer Guide (1) must be installed with the ramp (2) toward the back of the drawer, to prevent the drawer from being pulled out of the tray without engaging the tray latch. Failure to install the guide properly will cause the drawer stop to fail and cause damage or injury.

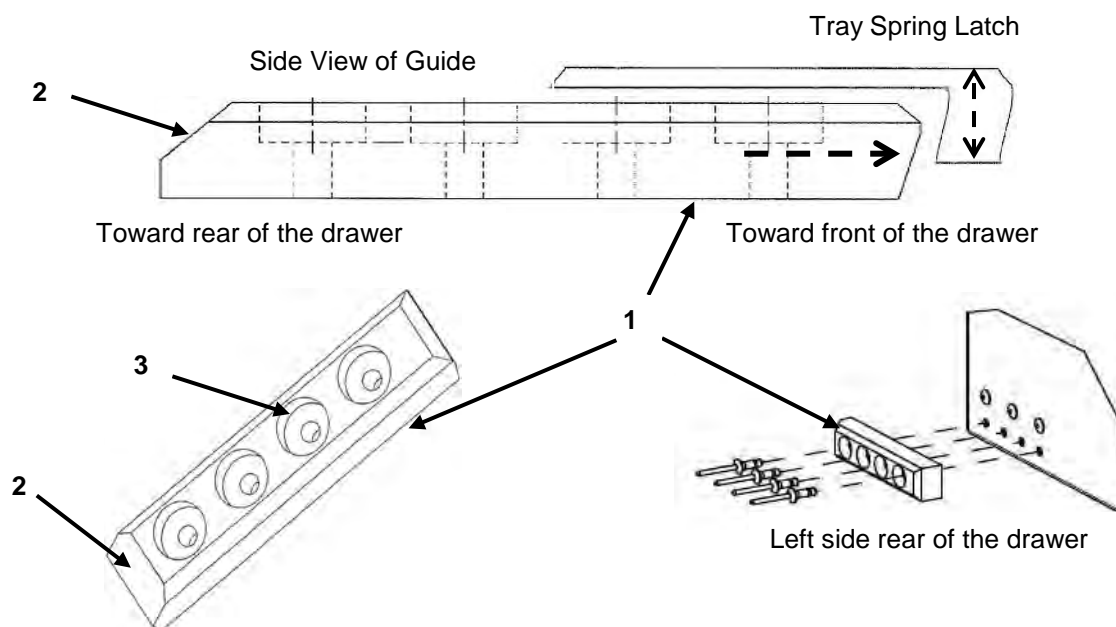

### CAUTION

Do not drill new holes for alignment; the holes provided are matched for proper alignment.

2. Coat the back of the guide with silicon, install the rivets, fill the rivet holes (3) flush and clean off excess silicon with a putty knife.
3. When the silicon is set, lubricate the guides with WD40 lubricant spray.

**CAUTION**

Do not drill new holes for alignment; the holes provided are matched for proper alignment.

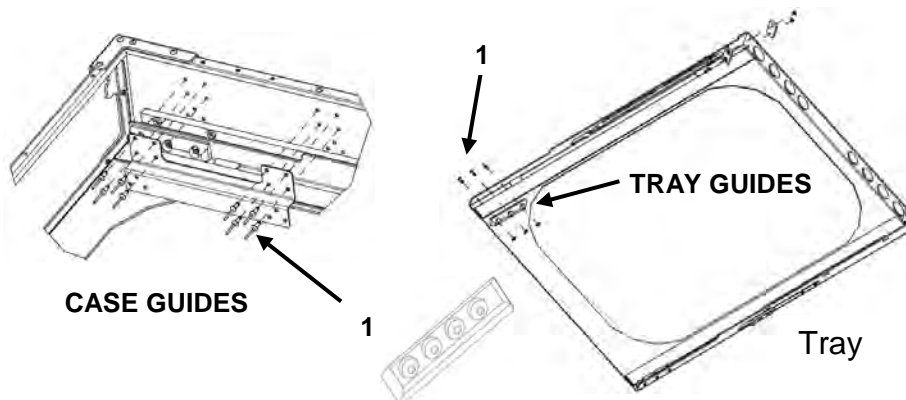
**CAUTION**

Never use other than the proper rivets from the kit to attach the slide pads.

4. Insert a new rivet, 3/16" DIA, rivet shank (1) through the holes of both items, and align the slide pad position.

**NOTE**

Insert a second rivet into another hole as a guide for alignment.

5. Use the pop rivet tool (2) to secure the replacement slide pad.

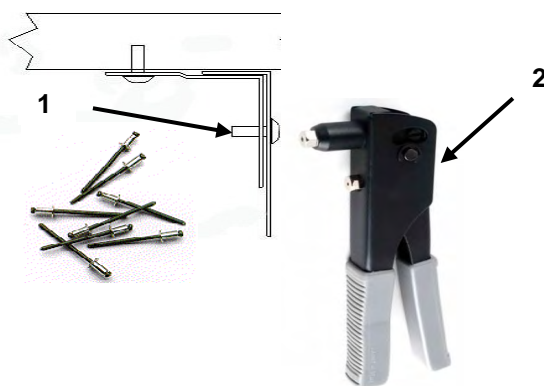

6. Check for proper alignment and tight attachment of the slide pads.
7. Install the remaining rivets.
8. Return the tray and case assembly to the stack.
9. Install and tighten the front and rear ratchet straps to the stack.
10. Return the drawer and tray assembly, review chapter 2 WP 0006 00.



## REPLACE SPRING LATCH

1. Remove damaged semi-tubular rivet (1), see page WP 0023 00-2.
2. Insert a semi-tubular rivet (1) through existing holes in the latch (2) and tray (3).
3. To replace the latch (2), grind off the two plug welds (4), remove the rivet (1).
4. Reweld the plug welds (4) and install new latch with new semi-tubular rivet (1), refer to TC 9-237 for welding procedures.
5. Repeat the process on the left side of the tray (3) if required.

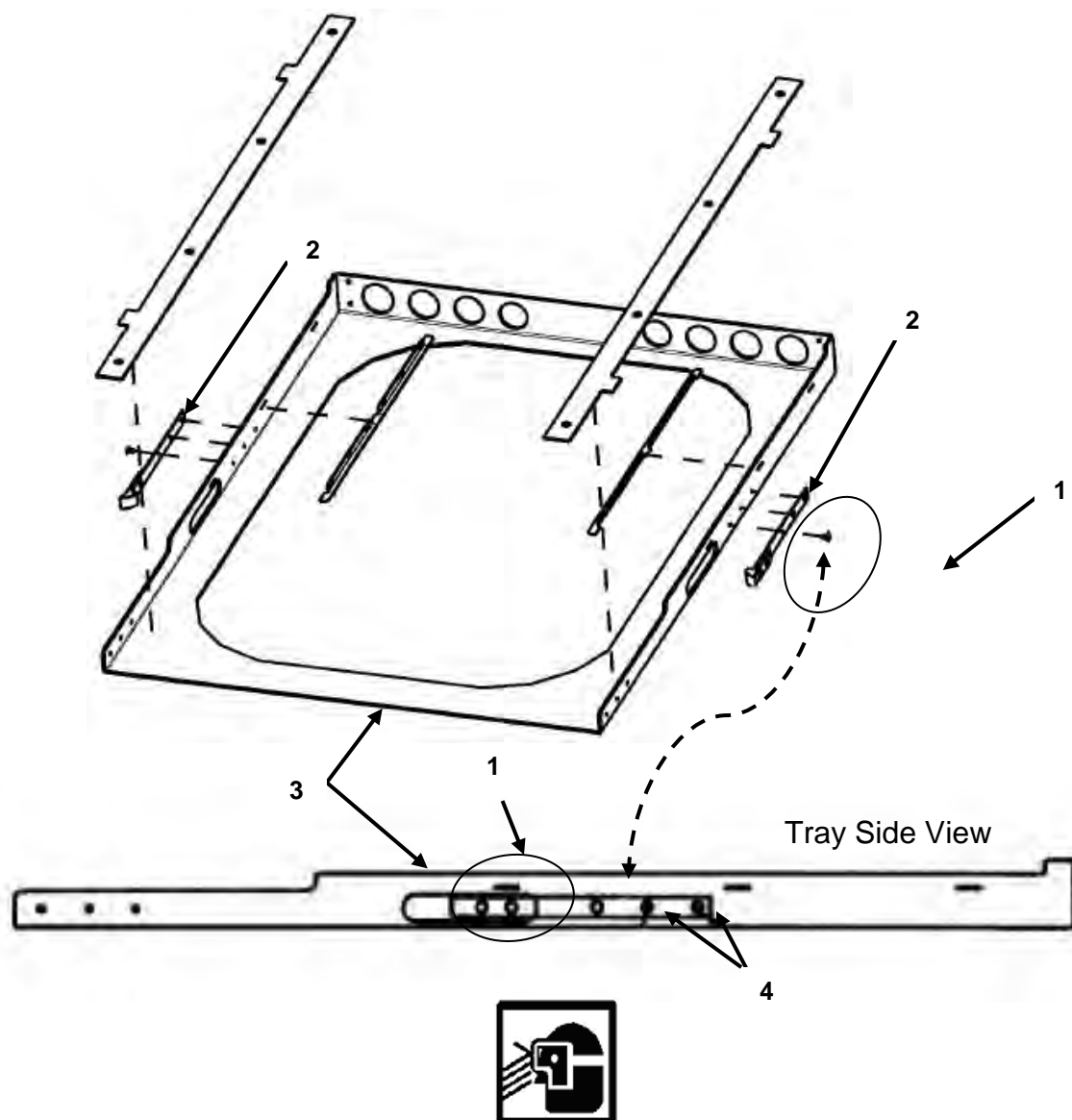

**WARNING**

Use proper eye protection when operating a drill or grinder or when welding.

**RESTACKING**

1. Install the tray in the case (1)
2. Place the case and tray assembly on the stack.
3. Reinstall the drawer into the tray and case assembly.

**WARNING**

Seek assistance to return tray and case assembly (1) to the module stack, only then, install the drawer.

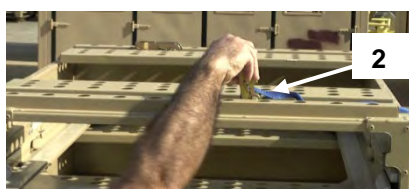
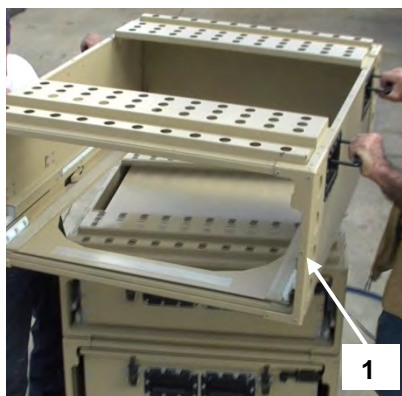
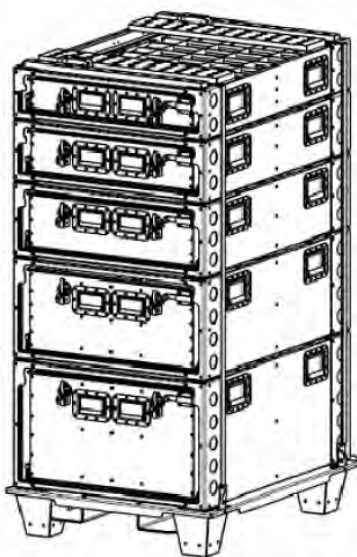

4. Reinstall both ratchet straps (2).

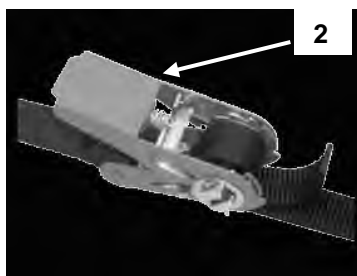
**END OF WORK PACKAGE**

BOH-PM-03-5  
Chapter 5 Rev. 4.02